

HP SmartStream software for HP PageWide XL and HP DesignJet printers

Your large format production workflow—two times more efficient¹



Speed

Do jobs in 50% of the time¹

- Meet the tightest deadlines with ultra-fast HP SmartStream Preflight Manager file analysis and processing
- Reduce reprints—use native PDF management with the Adobe PDF Print Engine² to cut potential printing issues
- Stop changing settings one by one—create presets to bundle all desired settings, then reuse as needed
- Stay productive with an easy and intuitive user interface

Efficiency

Streamline your production workflow

- Easily distribute the HP SmartStream configuration into different workstations—presets, hot folders, and printers
- Preview color just as it will print, and adjust settings with interactive HP Crystal Preview Technology
- Get the most out of your media with nesting designed to minimize paper waste
- Run HP and third-party accessories—online folders, stackers, take-up reels, cutters, and standalone scanners

Growth

Expand at your convenience

- Use with HP PageWide XL, HP PageWide XL Pro, and HP DesignJet printers for efficient GIS, and poster printouts³
- Provide accurate and timely quotes to customers before printing with HP SmartStream Pixel Analysis Module
- Easily reassemble and rename large file sets with HP SmartStream Document Organizer Module
- Manage JDF files submitted via web-to-print solutions with ease with HP SmartStream Workflow Management Module

To download the trial version, please visit:
hp.com/go/designjetSMARTstream_trial
hp.com/go/smartstreamPAGEWIDEXL_trial

¹ Using HP SmartStream software, job preparation and processing can be completed in 50% of the time. Based on testing commissioned by HP and performed by Sogeti in September, 2020 comparing select competitor printers that represent the majority market share of LED printers worldwide as of 2019 according to IDC, and software to HP SmartStream software, measuring the time required to extract pages from a 63-page document and print them using several printers compared with using equivalent software programs.

² The Adobe PDF Print Engine (APPE) is Adobe's high speed, high fidelity print platform. Version 4 extends APPE's leading edge for print reproduction with new performance efficiencies and breakthrough rendering features. APPE 4 enables printers to increase workflow efficiency and capitalize on the profit potential of innovations in inkjet print technology. To learn more, visit adobe.com/products/pdfprintengine

³ Support provided for a limited number of brands and models to be available after the introduction of HP SmartStream for HP PageWide XL, HP DesignJet, and non-HP large format printers. For more information, see hp.com/go/smartstream/trial



HP SmartStream software

Help improve your productivity and operator efficiency

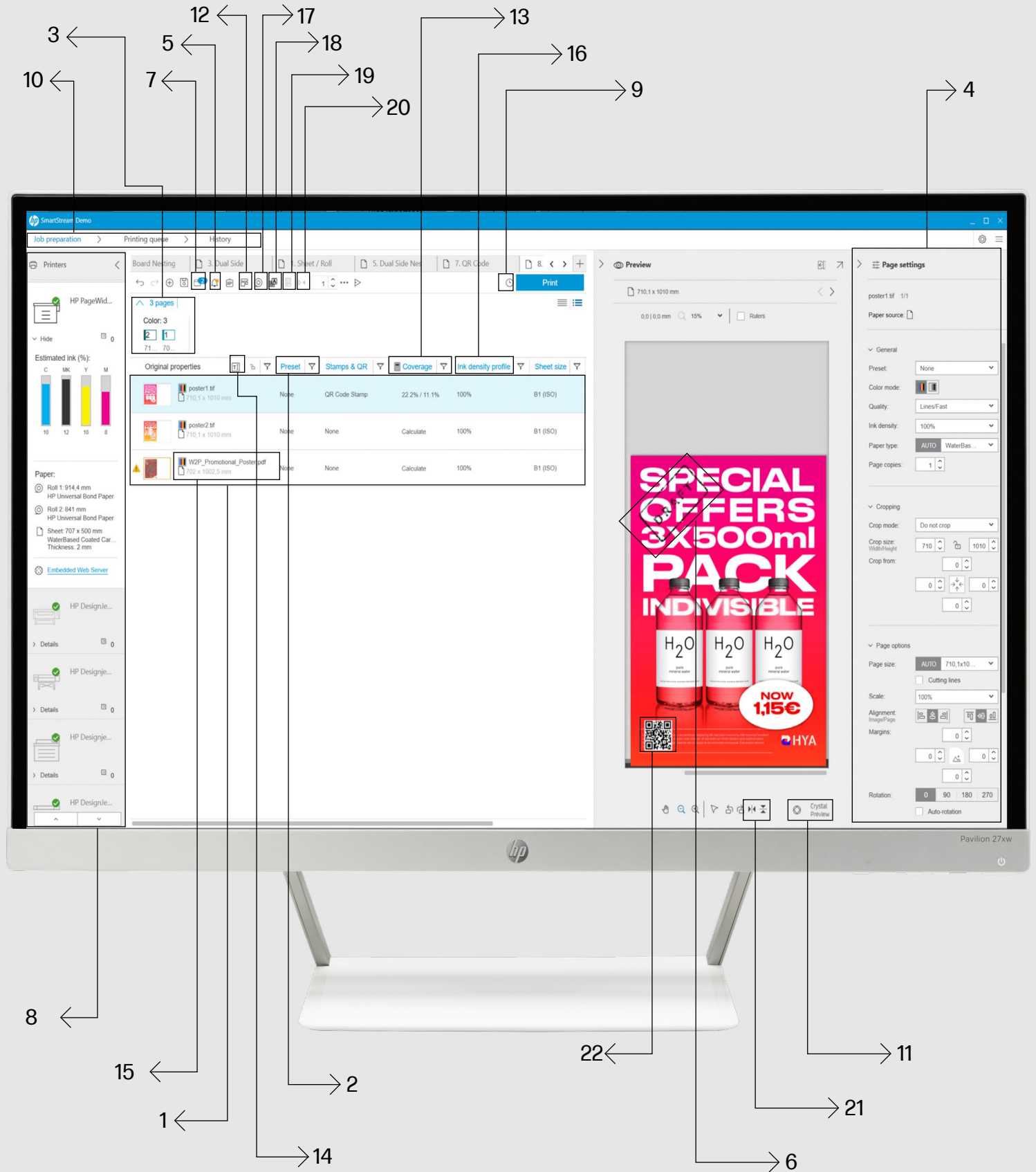

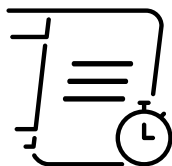

Speed

Finish jobs in 50% of the time¹

1. Paper size and type (color or monochrome) automatically detected
2. Save settings into a preset and apply them when needed
3. Use the classification of pages by size and color to apply settings or to (re)move them—simplify production of large jobs
4. Adjust all your printing settings per page, file, or job
5. Resolution center—automatic detection of potential PDF and layout issues
6. Add text or image stamps to jobs and save them as templates to reuse when needed

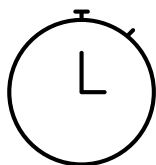

Efficiency

Enhance your production workflow

7. Submit jobs to HP SmartStream or directly to print through shared hot folders
8. Multi-printer support with detailed information about device status, ink level, loaded media, and integrated accessories
9. Prepare prints and put them on hold for release at a later time
10. Keep track of the status of your job through the printing queue and job history panel—job history allows you to easily make reprints
11. HP Crystal Preview Technology—preview color just as it will print
12. Help cut media costs with automatic nesting



Growth

Expand with color

13. Pixel analysis module—examine the pixel coverage of jobs before printing and get an accurate estimation of costs
14. Document organizer module—rename files, create different versions of files, and reorder pages to save time
15. Workflow management module—work with JDF files and automate your workflow with a smooth integration of SmartStream into your web-to-print
16. Ink density module—adjust the ink level in your PageWide XL Pro 10000 to fit your different applications

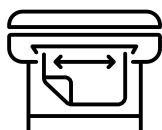

Amplification

Expand further with PageWide XL Pro

17. Change the media source from roll to sheet to enable new functionalities such as dual side printing
18. Print dual side sheets and boards in an optimized workflow with automatic flip ensuring proper registration between sides
19. Enable automatic nesting in dual side jobs in sheets and boards
20. Enable the side-to-side registration to visualize how the two sizes of your job will be positioned when printing dual sided
21. Apply horizontal or vertical mirroring to your images
22. Automatically generate QR codes as a stamp and add them into your job



Technical specifications

Supported file types	PDF, TIFF, JPEG, DWF(x), and HP-GL/2, even within a ZIP. All file formats supported with HP SmartStream Submission Driver
Supported HP PageWide XL printers and accessories	HP PageWide XL Pro Printer series HP PageWide XL Pro Stacker HP PageWide XL Pro Sheet Feeder HP PageWide XL Printer series ⁵ HP F70 Folder HP F70 Folder with Tab Applicator HP F60 Folder with Tab Applicator HP F40 Folder HP PageWide XL High-capacity Stacker HP PageWide XL Top Stacker HP SmartTracker software
Supported HP DesignJet printers and accessories	HP DesignJet T1700 Printer series HP DesignJet T1600/2600 Printer series HP DesignJet T7200 Production Printer HP DesignJet T7100 Printer (excluding the HP DesignJet T7100 Monochrome Printer) HP DesignJet XL 3800 Multifunction Printer HP DesignJet XL 3600 Multifunction Printer series HP DesignJet T3500 Production Multifunction Printer HP DesignJet Z6810 Photo Production Printer HP DesignJet Z9 ⁺ Printer series HP DesignJet Z6 Printer HP DesignJet Z9 ⁺ Pro Printer HP DesignJet Z6 Pro Printer
Note: HP SmartStream for HP PageWide XL and HP DesignJet printers supports PostScript [®] printers. Previous HP DesignJet printers could be compatible. Please check compatibility for previous models.	
Available languages	English, French, German, Spanish, Italian, Dutch, Japanese, Korean, Polish, Portuguese, Russian, Chinese, Taiwanese, Catalan
Delivery	Licensing system ⁸
Warranty	90-day warranty

Ordering information

Product	8SW00AAE	HP SmartStream Preflight Manager for HP PageWide XL and HP DesignJet printers
	8SW00A	HP SmartStream USB Preflight Manager for HP PageWide XL and HP DesignJet printers
	8SW01AAE	HP SmartStream Print Controller for HP DesignJet printers ⁹
	8SW01A	HP SmartStream Print Controller USB for HP DesignJet printers ¹⁰
	8SW02AAE	HP SmartStream Print Controller for HP XL 3xx0 Printer series
	8SW02A	HP SmartStream Print Controller USB for HP XL 3xx0 Printer series
	8SW03AAE	HP SmartStream Print Controller for HP PageWide XL 4x00 Printer series
	8SW03A	HP SmartStream Print Controller USB for HP PageWide XL 4x00 Printer series
	8SW04AAE	HP SmartStream Print Controller for HP PageWide XL 5x00/6000/8x00 Printer series
	8SW04A	HP SmartStream Print Controller USB for HP PageWide XL 5x00/6000/8x00 Printer series
	8SW05A	HP SmartStream Print Controller USB for HP PageWide XL Pro 5000/8000 Printer series
	8SW06AAE	HP SmartStream Print Controller for HP PageWide XL Pro 10000 Printer series
	8SW06A	HP SmartStream Print Controller USB for HP PageWide XL Pro 10000 Printer series
	8SW07AAE	HP SmartStream Print Controller Upgrade XL for HP PageWide XL Pro Printer series
	8SW07A	HP SmartStream Print Controller Upgrade USB for HP PageWide XL Pro Printer series
	2NH46AAE	HP SmartStream Document Organizer Module
	2NH47AAE	HP SmartStream Pixel Analysis Module
	6UA04AAE	HP SmartStream Ink Density Module ¹¹
	6UA02AAE	HP SmartStream Workflow Management Module

Minimum requirements

Computer hardware and software	Intel [®] Core [™] i3 2.4 GHz with 4 virtual cores/threads
	4 GB of RAM
	3.5 GB of free space on hard disk, plus 100 MB for each additional printer
	Screen resolution of 1280 × 1024 pixels, tuned or calibrated to sRGB for optimal HP CrystalPreview performance
	Ethernet, IPv4, 100 Mb/s
	Windows 10 and 11 and Windows server 2012, 2016, 2019, 2022

Note: Based on the minimum computer hardware and software requirements, it is not recommended to add more than 10 printers.

- 4 Using HP SmartStream software, renaming can be completed up to 70% faster. Conclusion based on an HP internal test, November 2020 comparing HP SmartStream Document Management module with equivalent manual process renaming a 85-page document.
- 5 Availability may vary by region.
- 6 Only available in Europe, the Middle East, and Africa.
- 7 Not available in Asia Pacific and Japan.
- 8 Licenses need to be installed in licensed server, which can be placed in a physical or virtual machine (VMWare Workstation, VMWare ESXi, Virtual Box).
- 9 License available for HP DesignJet T7100/7200, T1700, T1600/2600, T3500, Z6xx0, Z6/Z9.
- 10 License available for HP DesignJet T1700, T1600/2600, Z6/Z9.
- 11 License available for HP PageWide XL Pro 10000.

For more information, please visit
hp.com/go/smartstreampagewidexl
hp.com/go/smartstreamdesignjet

